

Replacement Parts List for Model # 210

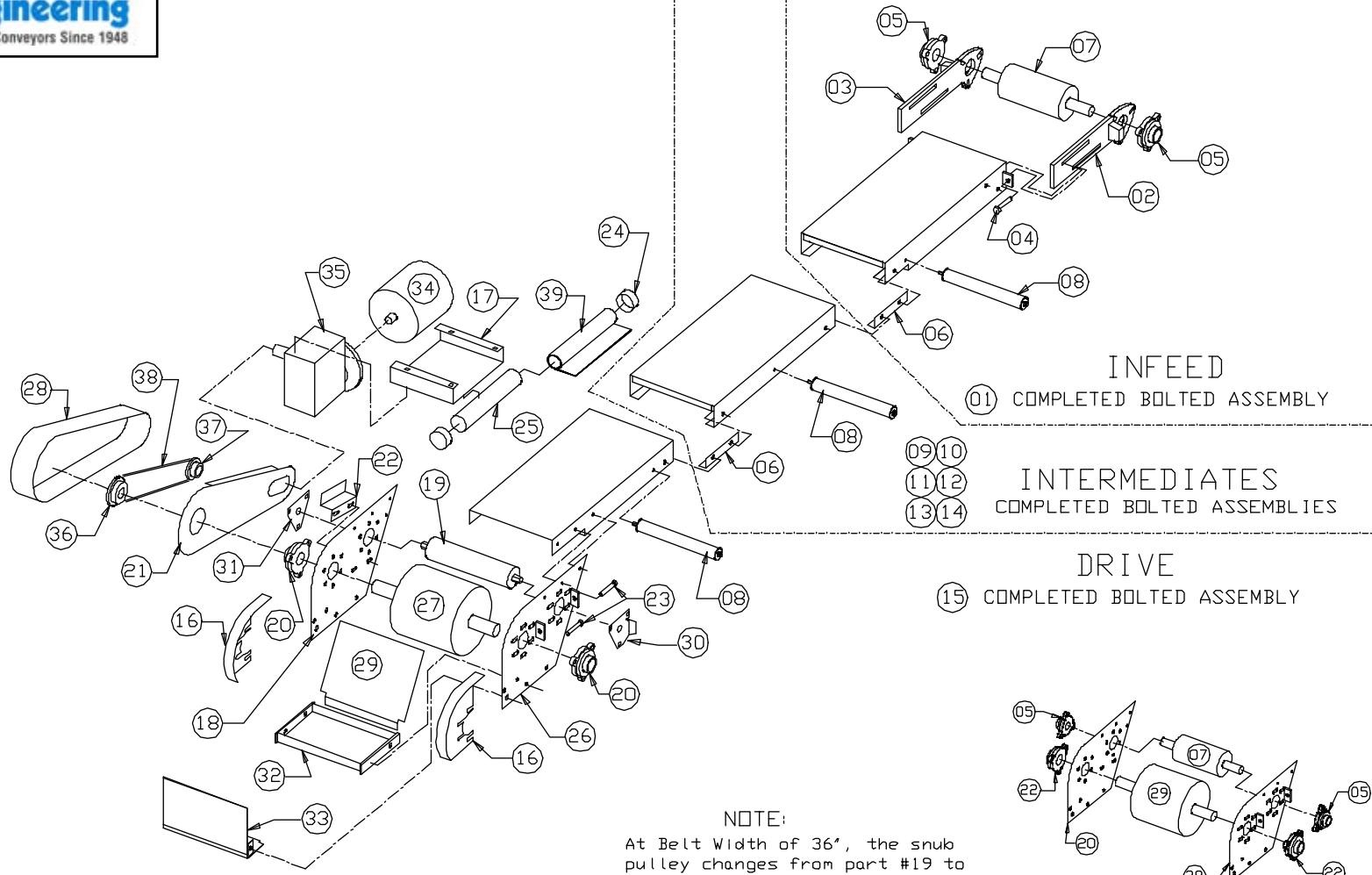

NOTE:
At Belt Width of 36', the snub pulley changes from part #19 to part #07; and the snub mount brackets #30 and #31 change to bearings #05, as shown at right.

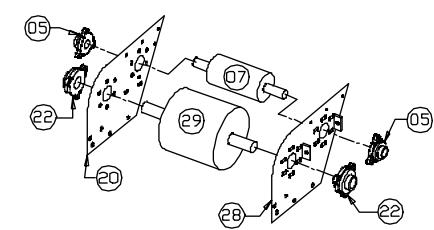

PN	Description	Quantity	Notes
01	Infeed Section Assembly	1	
02	• Left Hand Take-up Bar	1	
03	• Right Hand Take-up Bar	1	
04	• 1/2" x 6" Take-up Bolt	1	
05	• 1 3/16" 3 Bolt Flange Bearing	1	
06	Splice Link Angle	1	
07	• Infeed Pulley	1	
08	• Return Roller/Hex Shaft (4" dia CF x 1 3/16")	1	
09	6" Intermediate Section Assy	1	
10	12" Intermediate Section Assy	1	
11	24" Intermediate Section Assy	1	
12	48" Intermediate Section Assy	1	
13	84" Intermediate Section Assy	1	
14	120" Intermediate Sect. Assy	1	
15	Drive Section Assy	1	
16	End Pulley Guard	1	
17	Motor Base	1	
18	Right Drive Plate Weldment	1	
19	• Snub Roller/ Hex Shaft (1 3/8" x 5/16")	1	
20	1 7/16" 3 Bolt Flange Bearing	1	
21	Guard Back	1	
22	Drive Guard Bracket	1	
23	3/8" x 2 1/2" Push Bolt	1	
24	Manual Tube Cap	1	
25	Manual Tube Weldment	1	
26	Left Drive Plate Weldment	1	
27	• Drive Pulley (9" dia CFRL x 1 7/16")	1	
28	Guard Weldment	1	
29	Snub Guard	1	
30	Left Adaptor Bracket	1	
31	Right Adaptor Bracket	1	
32	Crossmember Weldment	1	
33	Drive Pulley Guard	1	
34	• Motor	1	
35	• Reducer	1	
36	• Drive Sprocket	1	
37	• Driven Sprocket	1	
38	• Chain	1	
39	Manual	1	

• Recommended spare parts to be stocked at your location